

M931DB LED Module

**Edge lit solution for 70-200mm depth single sided light box
and 80-400mm depth double sided light box**



ADVANTAGES

- 5 years warranty*
- Highly efficient 3535 flip eutectic SMD LED
- Superior luminous efficiency—103lm/W (white), 124lm/module
- Special lens to achieve optimal light distribution to match applications
- Constant current driving technology guarantees stable illumination performance
- Casing by flame retarded engineering plastic
- Good heat sink performance aluminium substrate integrated PCB
- IP65 over-moulded design suitable for outdoor sign applications
- UL, CE, RoHS compliant

* 5 years or 22,000 hours, whichever comes first

* Working within operating temperature

LIGHT DISTRIBUTION

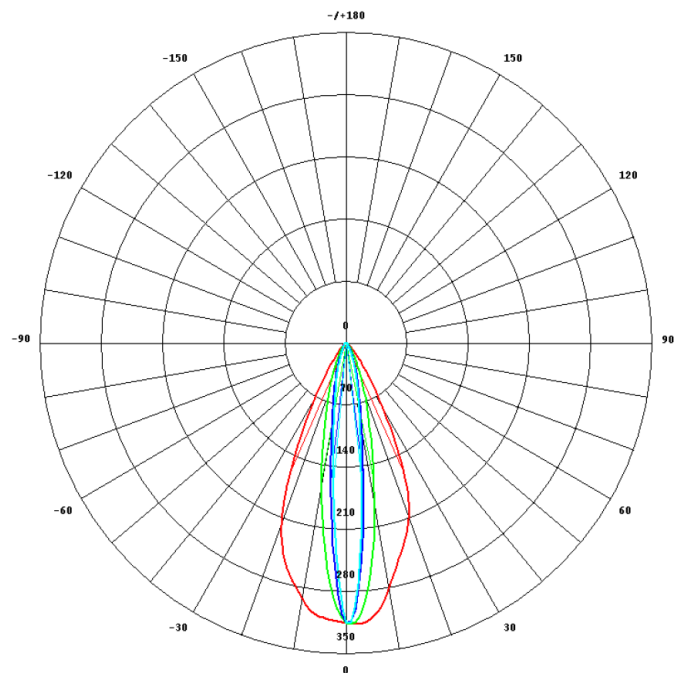

INSTALLATION

- Max. 30 modules per string
- Easy installation with 3M self-adhesive tape, permanent screw fixed
- Can cut every single module

ASTECH (a Division of the Albert Smith Group)

59 Taylor St Bulimba QLD 4171, Ph. 07 3395 9888 Fx. 07 3891 0713

Email: enquires@asgroup.com.au Web: www.albertsmithgroup.com.au

ABN. 42345973910

M931DB LED Module

**Edge lit solution for 70-200mm depth single sided light box
and 80-400mm depth double sided light box**

PRODUCT OPTIONS

P/N	LED Colour	Colour Temperature (K) Wavelength (nm)	Luminous Flux (lm/module)	CRI	Luminous Efficiency (lm/W)	Working Voltage (V DC)	Working Current (mA/module)	Power (W/module)
M931DB	Natural white	7000	124	≥70	103	12	100	1.2

OTHERS

P/N	Colour Option	Standard Cascading Qty (pcs)	Max Cascading Per String		Single Module Weight (g)	Operating Temperature (°C)	Storage Temperature (°C)	Ingression Protection Grading
			Single End	Double End				
M931DB	Natural white	30	30	N/A	30	-25 ~ +60	-25 ~ +70	IP65

PRODUCT PROFILE

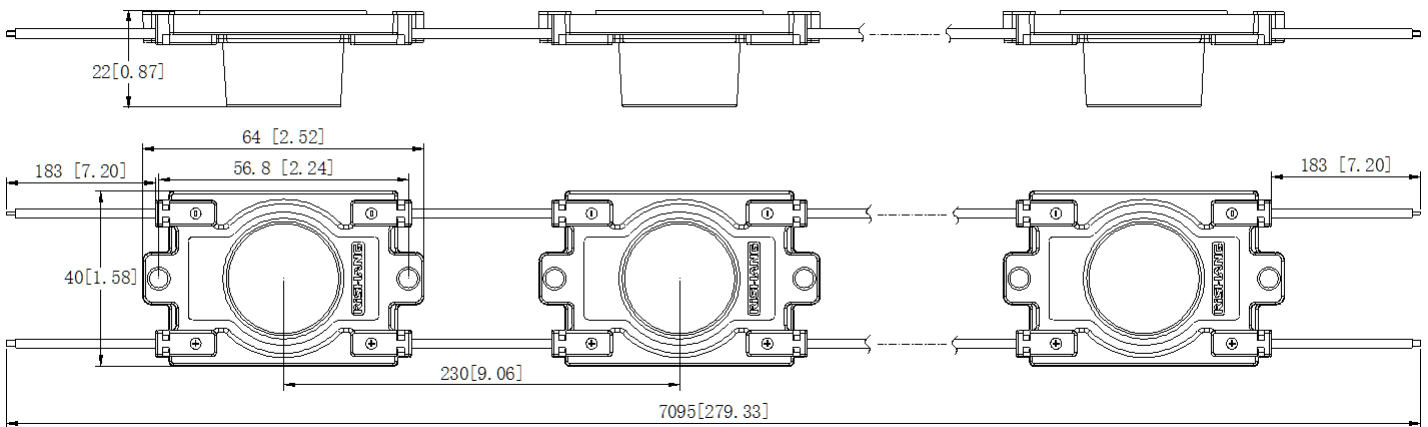

ASTECH (a Division of the Albert Smith Group)

59 Taylor St Bulimba QLD 4171, Ph. 07 3395 9888 Fx. 07 3891 0713

Email: enquires@asgroup.com.au Web: www.albertsmithgroup.com.au

ABN. 42345973910